



Your search for the
perfect luxury apartment
ends here!

LUXURY 3 BHK APARTMENTS

JUBILEE HILLS, HYDERABAD, INDIA

Swipe to know project details 



**Fresh perspective
in luxury living!**



Hyderabad's best is now located in the affluent suburban neighbourhood of Jubilee Hills/Madhapur.

Oak a project by Celebrity Prime is an upmarket residential area surrounded by the most enthralling places of this town.

Providing you with the lifestyle you deserve, Oak apartments guarantee regal living at its best.

HURRY UP!
ONLY FEW UNITS
AVAILABLE!





Typical Floor Plan • A

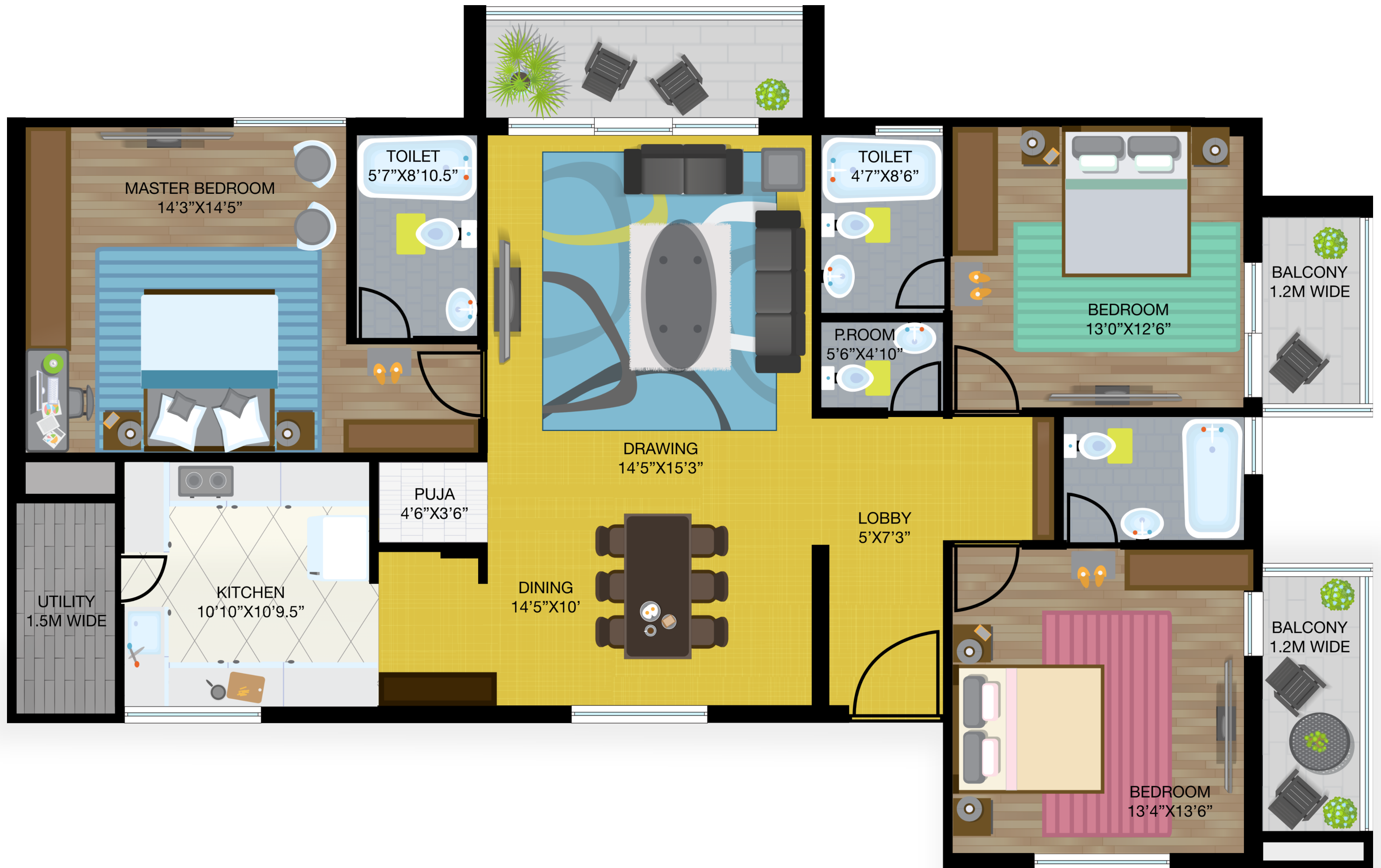

2076 sq ft



Typical Floor Plan • B

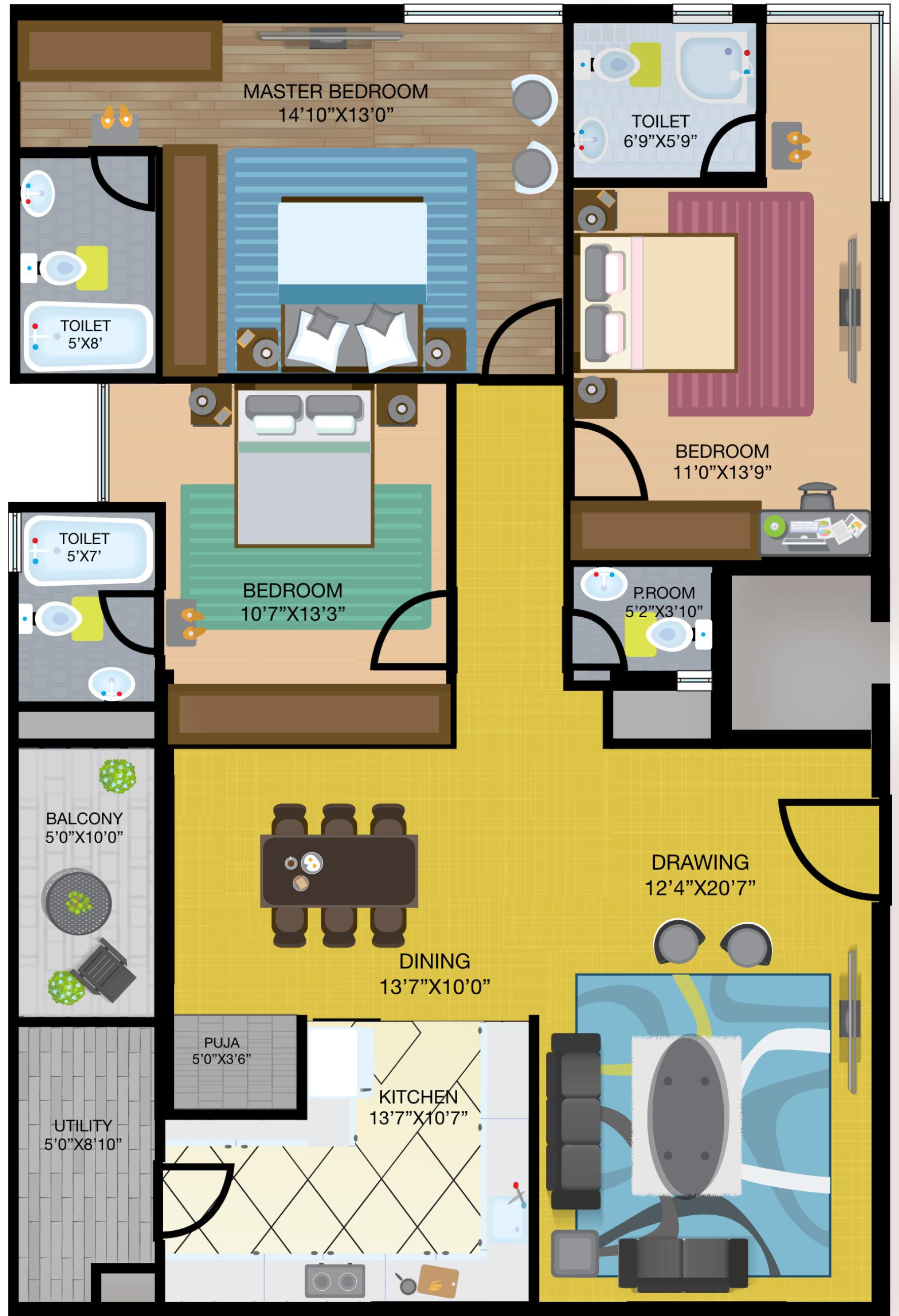

1918 sq ft



Amenities



- ✔ Swimming pool & Toddlers pool with wooden deck
- ✔ 24 hour security / CCTV surveillance
- ✔ Fully equipped Gymnasium
- ✔ Eco friendly landscape as per design
- ✔ Rainwater harvesting system
- ✔ 100% power back up for all common areas
- ✔ Gas power bank provision

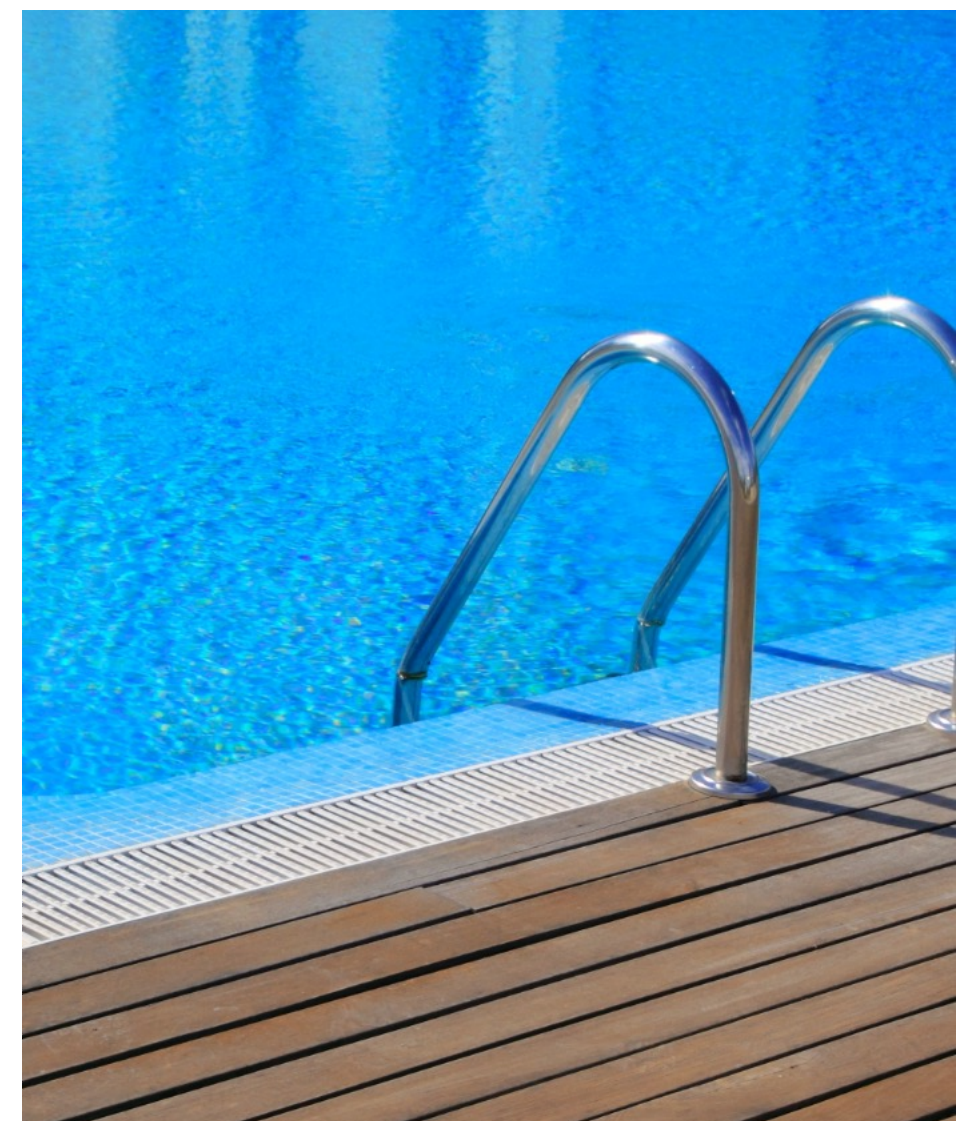



Location Highlights



- ✔ 10 mins drive to Hitech City
- ✔ 15 mins drive to Financial District
- ✔ 30 mins drive to Begumpet
- ✔ 10 mins drive to Next Galleria Mall - Hitech City & PVR Theatres
- ✔ Close to international schools like Chirec International School, Orchids The International School & Mosaica International School
- ✔ 40 mins drive to RGIA • Rajiv Gandhi International Airport
- ✔ 10 mins drive to IKEA
- ✔ 10 mins drive to Gachibowli
- ✔ 15 mins drive to ORR
- ✔ 15 mins drive to KBR Park





Specifications

STRUCTURE

RCC Structure designed to withstand wind & Seismic loads.

WALL FINISHES

Internal • Smooth putty finish with two coats of premium acrylic emulsion paint of reputed make over a coat of primer.

External • Textured finish & two coats of exterior weather proof emulsion paint of reputed make.

FLOORING

Drawing / living / Dining / Bed rooms / Kitchen • 800 x 800 mm size Double Charged vitrified tiles of reputed make.

Master bedroom • Engineered wood

Bathrooms • Acid resistant, anti-skid 10"x 15" ceramic tiles

Common Areas / Amenities / Corridor • Double charged vitrified tiles of reputed make

Stair case • Granite finish.

TILES CLADDING

Kitchen • Glazed ceramic tiles up to 2'-0 height above kitchen platform

Bathroom • Glazed ceramic tiles dado up to 7" height

Utilities • Rustic vitrified tiles

Wall tiles dado up to 3'-0.

KITCHEN

Granite platform with stainless steel sink.

Provision for fixing water purifier, exhaust fan & chimney.

ELECTRICAL

Concealed copper wiring (polycab).

Power out let for Air conditioner in all rooms.

MCB for each distribution boards.

Elegant designer modular electric switches.

Power outlet for Geysers in all Bathrooms.

Power plug for Chimney, Refrigerator, Microwave, Ovens, Mixers/Grinders in Kitchen. Washing machine & Dish washer in Utility area.

TELEPHONE

Telephone point in all bedrooms and drawing room.

SANITARY AND PLUMBING

Ceramic ware of reputed make

Provision for geysers in all bathrooms

All C.P fittings are chrome plated of reputed make

Vanity type Wash Basin

EWC with concealed Cistern of Reputed make

POWER BACK UP

All common Areas & Amenities, STP & lifts are fully supported by generator for uninterrupted power supply.

Inverter wiring for all apartments

WATER SUPPLY

CPVC of Astral make for external lines & internal lines piping.

Sanitary & rain water piping • PVC piping of reputed make.



ELEVATORS

An automatic 6 passenger lift with rescue device & V3F for energy efficiency.

EXTERNAL HANDLE RAILING

MS painted railing for stair case & balconies

TERRACE ROOF

Terrace slab is insulated & water proofed

PREMIUM SPECS • OPTIONAL

Yale Biometric Digital Mortise Lock • 3 way operations i.e. fingerprint, digital pin code & key. Provides voice guide

Fully fitted wardrobes with sliding shutters with mirror/veneer as per design

False ceiling in all areas including bathrooms & balcony

Modular kitchen of reputed make

Home automation

